

## BZ SERIES | Non-Clog Submersible Pump

Solids handling non-clog submersible pump with unique channel impeller designed for raw sewage in municipal, industrial and commercial effluent and wastewater. Up to 15HP and 4" discharge.

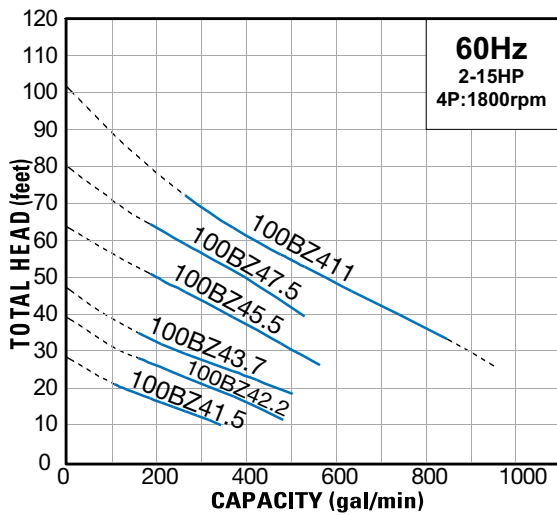

With TOS Guide Rail System



REMARKS:  
Not Recommended for Continuous Operation On Dashed Curve.

Dimension: Free Standing A / B / C

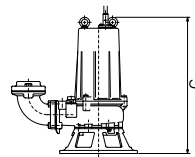
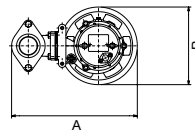

Dimension: Guide Rail Fitting (TO / TOS) D / E / F

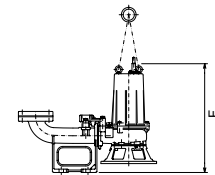
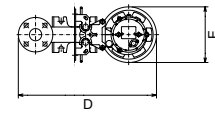

Three Phase Model	Motor Output (HP)	Rated Current Amps				RPM	Discharge Size (in.)	Dimensions (in.)						Max. Solids Dia. (in.)
		208V	230V	460V	575V			Free Standing Models			TOS Guide Rail Models			
								A	B	C	D	E	F	
100BZ41.5	2	8.0	8.0	4.0	3.0	1800	4	22 1/2	10 3/4	24 13/16	28 5/16	10 3/4	25 7/16	3.15
100BZ42.2	3	9.8	9.2	4.6	3.6	1800	4	22 1/2	10 3/4	24 13/16	28 5/16	10 3/4	25 7/16	3.15
100BZ43.7	5	15.0	14.2	7.3	5.4	1800	4	23 13/16	11 3/8	26 13/16	29 5/8	11 3/8	27 3/8	3.15
100BZ45.5	7.5	22.6	20.5	10.3	8.1	1800	4	29	16 9/16	36 3/8	37 3/16	16	36	3.15
100BZ47.5	10	28.8	26.6	13.4	10.8	1800	4	29	16 9/16	37 3/16	37 3/16	16	36 13/16	3.15
100BZ411	15	42.2	39.2	19.5	15.7	1800	4	29 7/16	16 15/16	40 1/4	37 5/8	16 7/8	40	3.15